

This is an interactive PDF form. When finished please print the form for your records and fax or email a copy to PMH. To email simply click on the Submit by Email button to send the information to PMH. Your computer must be connected to the internet to send the information via the internet. The comprehensive warehouse questionnaire allows the user to compare warehouse layout and storage results for selected forklift types.

Date

Contact Information

Company Name

Project Name

email

First Name

Last Name

Phone Number

Address

Fax Number

City

State

Zip Code

The resulting information and warehouse layout is strictly based on the data supplied by the user - missing - incomplete or inaccurate data will have varying results. PMH provides the warehouse layout and comparative output data as a service for warehouse planning & evaluation. This is a free service provided by PMH, solely at its own discretion. PMH is under NO obligation to provide for or deliver to the user the output data or warehousing layout evaluation. Use of the information provided by PMH is solely the responsibility of the end user, in NO case shall PMH be liable for the content, its use to plan / purchase / design or implement facilities or equipment without prior express written consent from PMH.

The resulting output data is provided in a pdf format, the warehouse layout can also be provided as drawing file.



Facility Information

Please select an option from the drop down lists. If other enter a brief description in the provided field.

Please select one Storage Selection Desired storage qty Number of Pallets

Other description Pallets moved per hour in/out of storage Throughput Pallets / Hour

Warehouse Restrictions Feet Inches

Clear Storage area height

Storage area Length

Storage area Width

Detail Information

Height Configuration

Load Height useage

Number of Profile Height Positions

Detail Information

Inches ONLY!

Enter the dimensions for each profile point. Start with (A) = 0, Ht = ??? provide the height for A in inches. The value for (B) is the distance from A. Please enter all values in inches. (C) is the distance from A again etc.

A-A	Ht	<input type="text"/>
A-B	Ht	<input type="text"/>
A-C	Ht	<input type="text"/>
A-D	Ht	<input type="text"/>
A-E	Ht	<input type="text"/>
A-F	Ht	<input type="text"/>
A-G	Ht	<input type="text"/>
A-H	Ht	<input type="text"/>
A-I	Ht	<input type="text"/>
A-J	Ht	<input type="text"/>

The final profile point should equal the overall width of the warehouse storage area and the final height dimension.

Height profiles may not coincide with a building column locations.

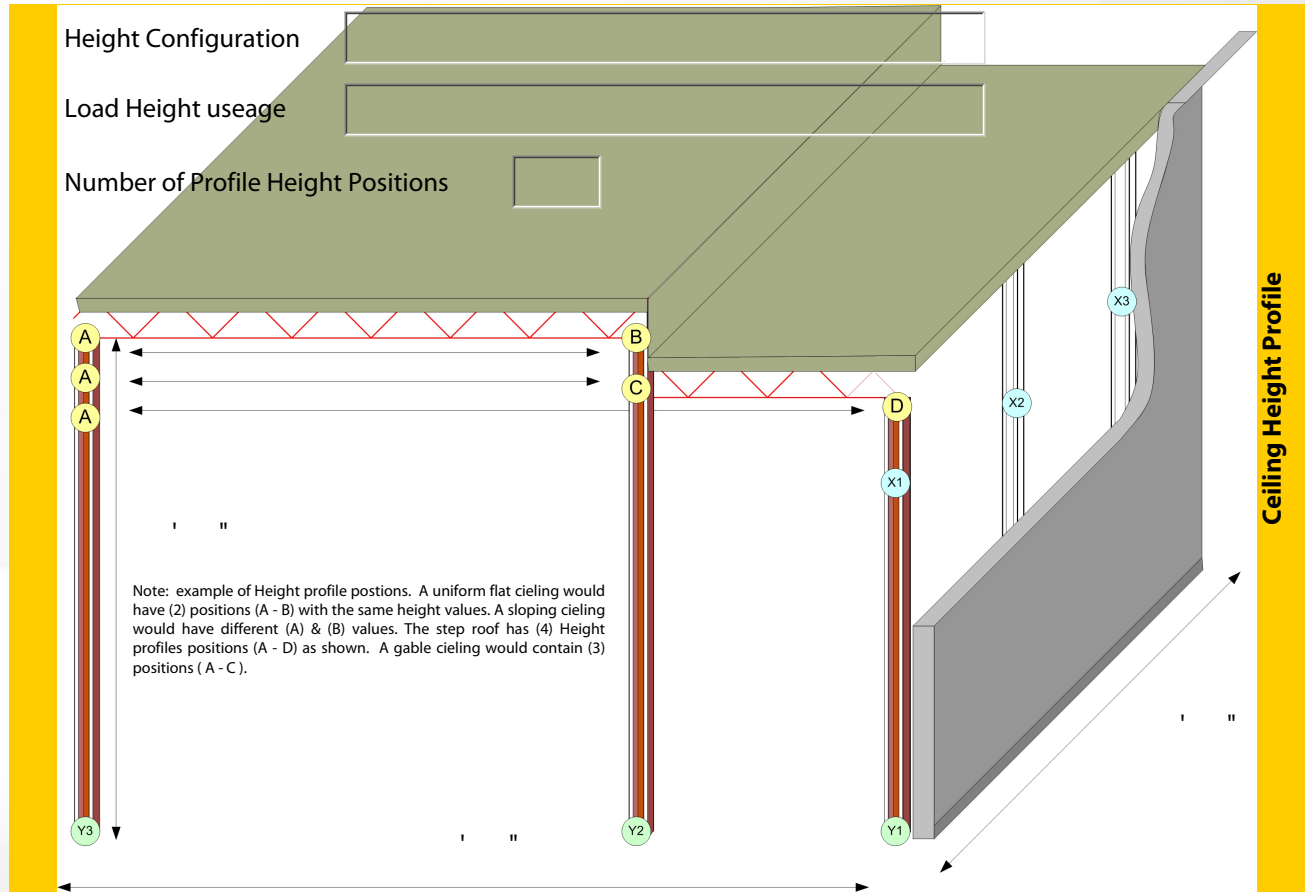

Building Columns

Rack or self supporting roof - NO further building column information required.

Irregular building column placement enter the information below:
Please number the building columns in the x and y direction.

Number of Columns in the X direction:

Number of Columns in the Y direction:

Enter the information for each Column as required.

Measure the distance from the wall or start position in X & Y direction for each column in the layout as well as the column length and width:

Column distance from Wall or start position (inches) ● Column dimension length & width (inches)

X1	Y1	x1	y1
X2	Y2	x2	y2
X3	Y3	x3	y3
X4	Y4	x4	y4
X5	Y5	x5	y5
X6	Y6	x6	y6
X7	Y7	x7	y7
X8	Y8	x8	y8
X9	Y9	x9	y9
X10	Y10	x10	y10
X11	Y11	x11	y11
X12	Y12	x12	y12
X13	Y13	x13	y13
X14	Y14	x14	y14
X15	Y15	x15	y15
X16	Y16	x16	y16

Uniform building column placement please enter the following information:

Distance between Column X1 and the wall or start position in (X) direction:

Distance between Column Y1 and the wall or start position in (Y) direction:

Distance between Columns in (X) direction:

Distance between Columns in (Y) direction:

Column dimension (X) direction:

Column dimension (Y) direction:

Inches

	●
	●

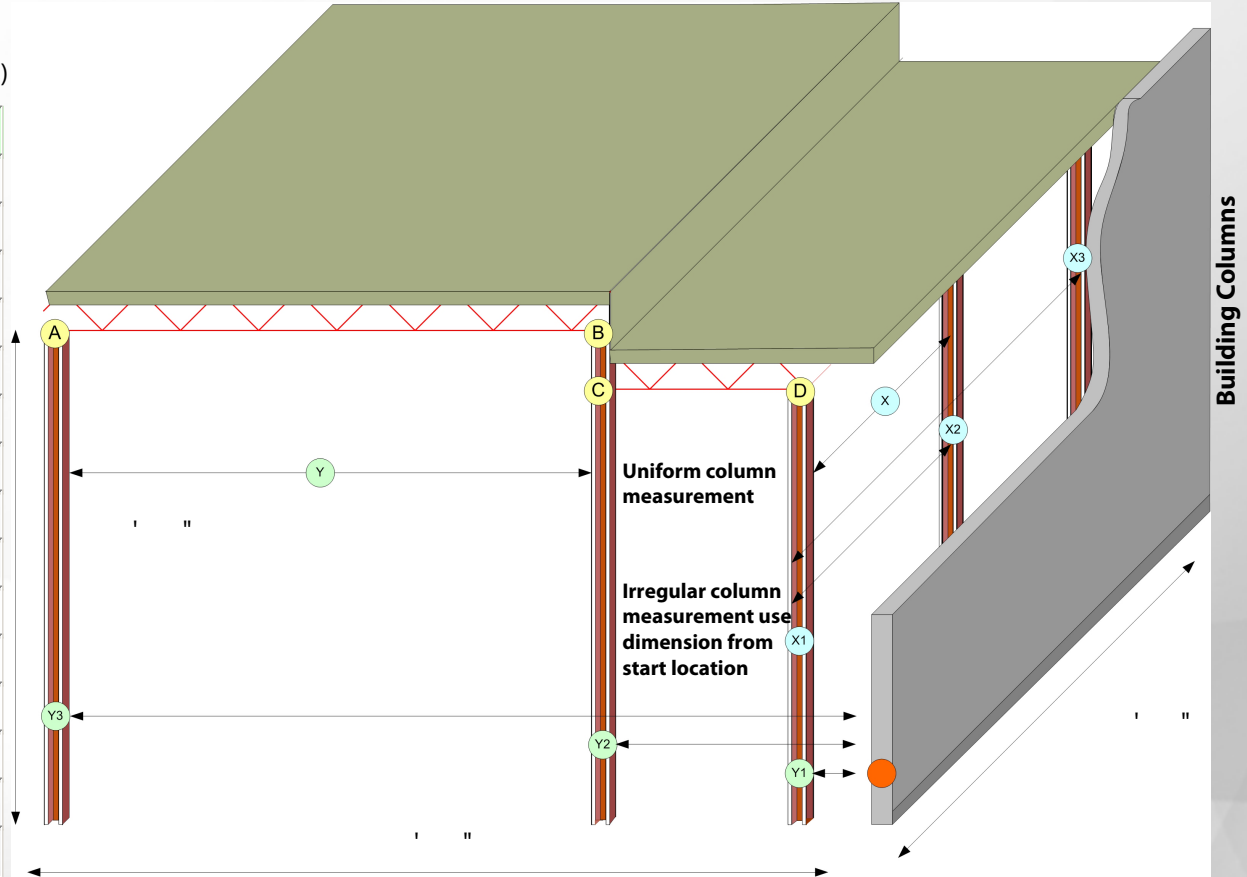

For larger warehouses or storage areas please submit additional column information in a spread sheet format or submit a drawing file. Additional Information



--	--	--	--

Functional Storage Area

 In the Layout if the RACK Rows should start at a location other than Y = 0
Please enter the offset distance where the row should start.
eg. distance from outer wall or column see fig above.

Staging area	<input type="text"/>	Staging area width	<input type="text"/>	Inches	Offset Location of Rack Row Start from Y = 0	<input type="text"/>	Inches
Intersecting Aisle	<input type="text"/>	Intersecting Aisle width	<input type="text"/>		Lowest Obstruction to negotiate (eg door)	<input type="text"/>	
Center Aisle	<input type="text"/>	Center Aisle width	<input type="text"/>		Existing clear working aisle width (load to load)	<input type="text"/>	
Position of Center aisle from layout center 0,0 (-) toward the front of the layout and (+) to the rear. Place +/- in front of offset value.		Center Aisle offset (- /+)	<input type="text"/>		If rail guided enter rail to rail dimension	<input type="text"/>	

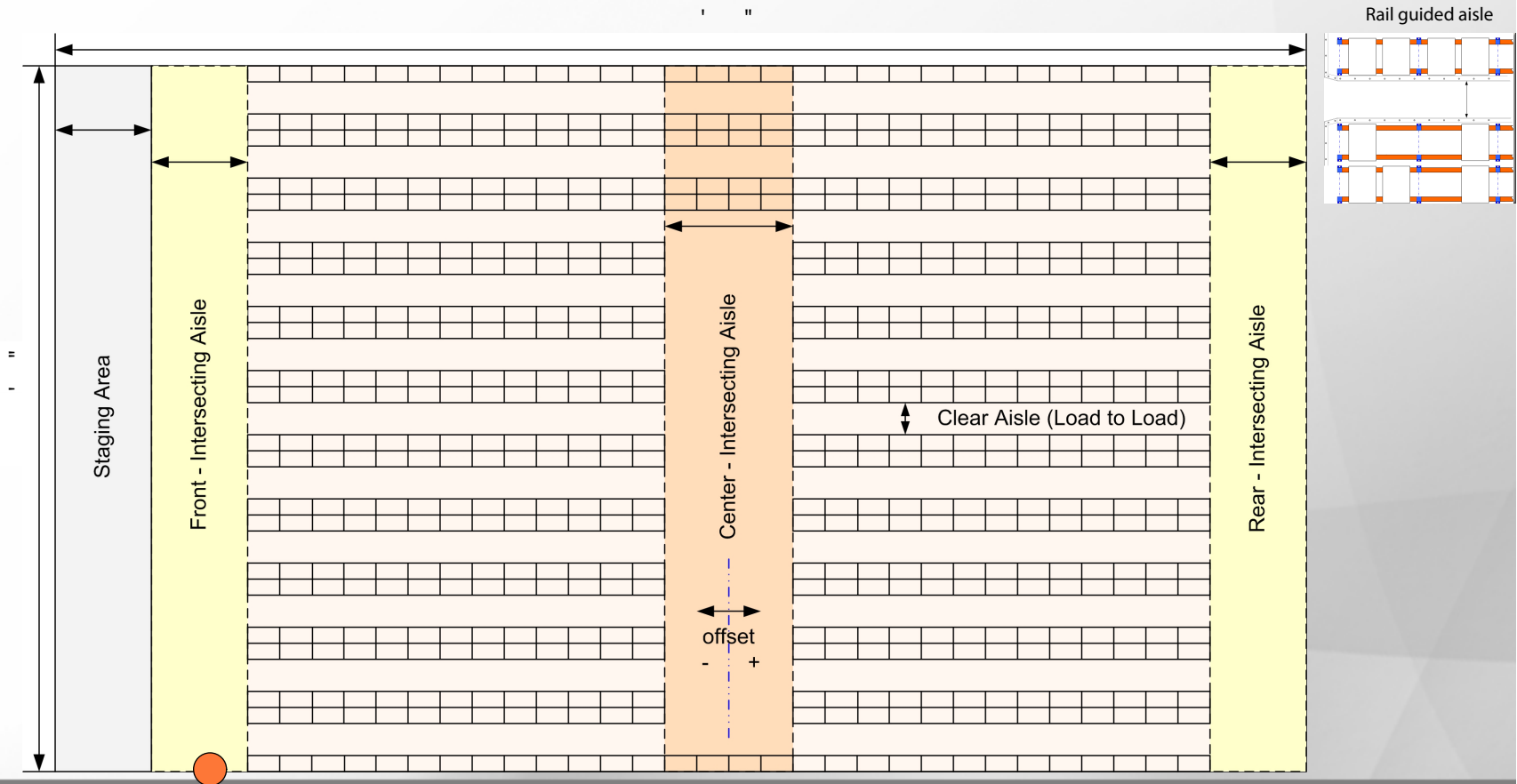

Loads

Load Type

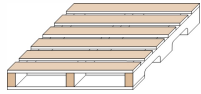

Please enter both pallet and load dimensions

Pallet Size

Load size includes Pallet Overhang

Insertion Length Inches

Insertion Length Inches

Load Height

Width parallel to aisle

Width parallel to aisle

Load Info

After entering the Load Size, please SELECT one of the representations that matches the load configuration:

No Load Overhang

Overhang in Length

Overhang in Width

Overhang Length & Width

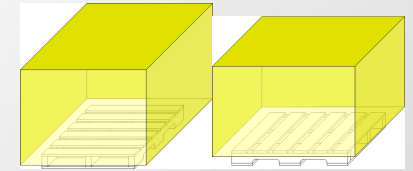
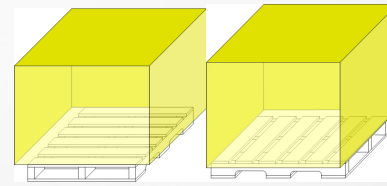
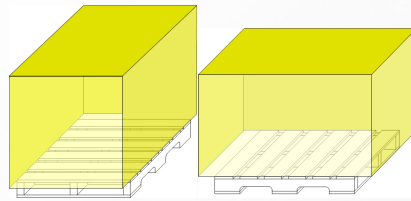
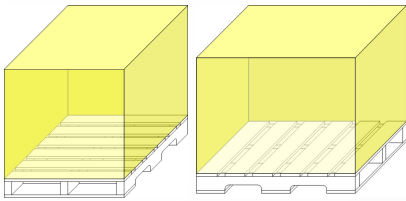

Unit Load Information

Load Overhang

Do you intend to handle various load sizes ?
If yes please select the maximum size.

Yes / no

Maximum Load Size

VNA Turret Trucks maintain their capacity ratings at higher elevations than conventional lifts. Please consider the maximum load weight at the desired elevation as well as the lower storage regions.

MaxLoad Weight



Rack Information

Clear space between loads (parallel aisle)

Inches

Clear height space between top of load and beam

Clear space between adjacent loads back to back

Loads per rack bay / level eg. 2

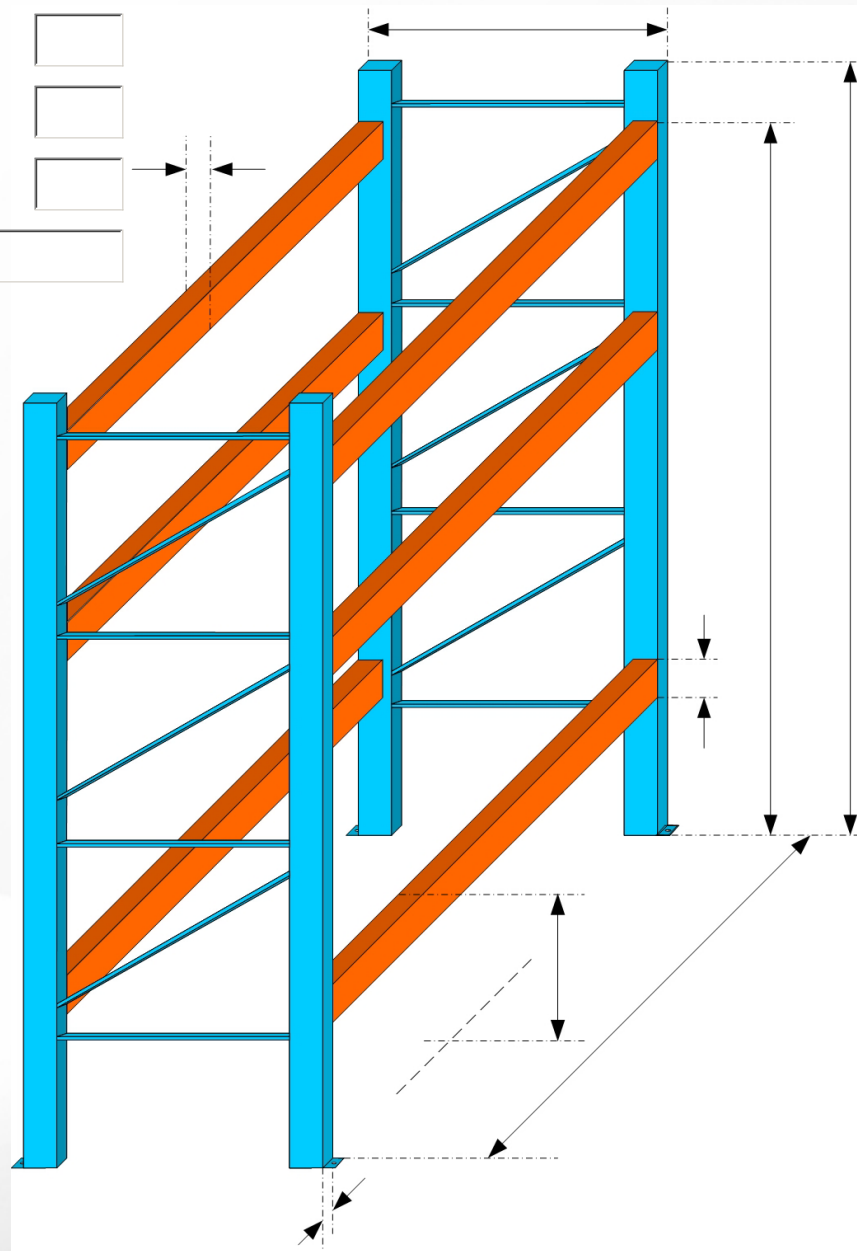
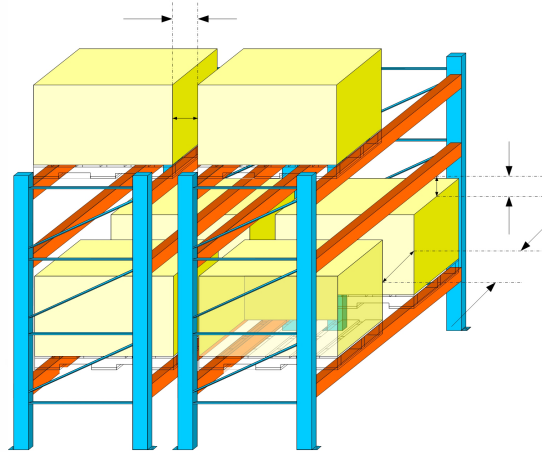

- Inches
- Beam width (under pallet)
 - Rack Upright depth
 - Rack Upright Height
 - Top beam height
 - Beam height dimension
 - Height of lowest load level
eg. floor = 0"
 - Upright Post width
(parallel to the aisle)
 - Beam length dimension
(calculated value)

Forklift Information

Select vehicle type

Enter Vehicle Mfg

Enter Vehicle model

Click the check box under the pictured vehicle for sample data - modify as necessary



VNA Turret



4-Wheel



Reach Truck

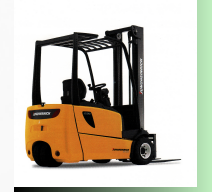

3-Wheel



Straddle walkie

Required Working Aisle with previously specified load

 in.

Travel Speed capability (max.)

 mph

Collapsed or lowered height of mast

 in.

Travel Speed acceleration

 ft/sec²

Allowable diagonal travel height

 in.

Travel Speed deceleration

 ft/sec²

Overall Extended height of forklift

 in.

Load / unload cycle time

 sec

Fork height

 in.

Fork Cycle consumption

 Wh

Lowest Pickup point (eg. floor = 0")

 in.

Travel 325' (100 meter) only NO Load

 Wh

Lift speed maximum

 fpm

Travel 325' (100 meter) WITH LOAD

 Wh

Lift acceleration

 ft/sec²

Lift 32' (10 meter) or max height NO Load

 Wh

Lift slow down - deceleration

 ft/sec²

Lift 32' (10 meter) or max height WITH LOAD

 Wh

Forklift Capacity

 lbs

Battery Voltage of Vehicle

 V

Availability / Usage Man & Machine (industrial avg. 75)

 %

Battery Capacity of forklift model

 Ah

Please fill in as much data as possible. Some data may only be available from the manufacturer in which case PMH will substitute generic values for performance and power consumption values. The information supplied is used for comparison purposes. Click below the pictured vehicle for sample data - modify as necessary.



Overview

We would like to take this opportunity to thank you for allowing PMH to assist with your Facility Storage Planning requirements. Please review the completed form and print a copy for your files. To submit the entered information, simply click on the "Submit by Email" button. The form information will be sent via your default email program to PMH for processing. Once the information has been received an email response will be sent to the link you provided. The results will be emailed to this address.

If you would like to submit another project or vary the information on the submitted form please click the "Reset Form" button below to clear all previous information. Submit additional requests with unique project names eg. mywarehouse1 .. 2 etc.

